

Feature :

1. Support Micro-ATX form factor motherboard
2. High-airflow thermal design with 5 × 4056 fans and smart fan controller
3. Support 2 x 2.5" SATA tray(full-height)
4. Support 1 expansion slot

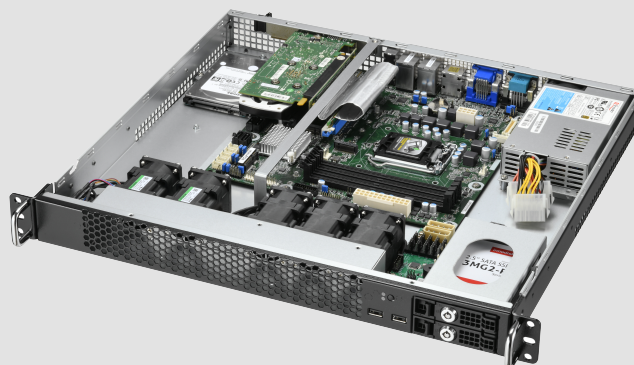

Specifications :

Front Panel	<ul style="list-style-type: none"> ● Power Switch x 1 ● Power LED x 1 ● HDD LED x 1 ● USB Port x 2 ● 2.5" SATA Tray x 2
Back Panel	<ul style="list-style-type: none"> ● Universal I/O Shield x 1 ● Expansion Slot x 1
Internal Structure	<ul style="list-style-type: none"> ● Fan Controller x 1 ● 4056 Cooling Fan x 5 ● Air Duct x 1 ● 2.5" HDD x 1
Dimensions (W x D x H)	17.0 x 15.74 x 1.73 inch (431.8 x 399.9 x 44.0 mm)
Material	Heavy dust cold-rolled steel.
Surface	Black wer paint with texture coat
Color	Black. Customizable colour

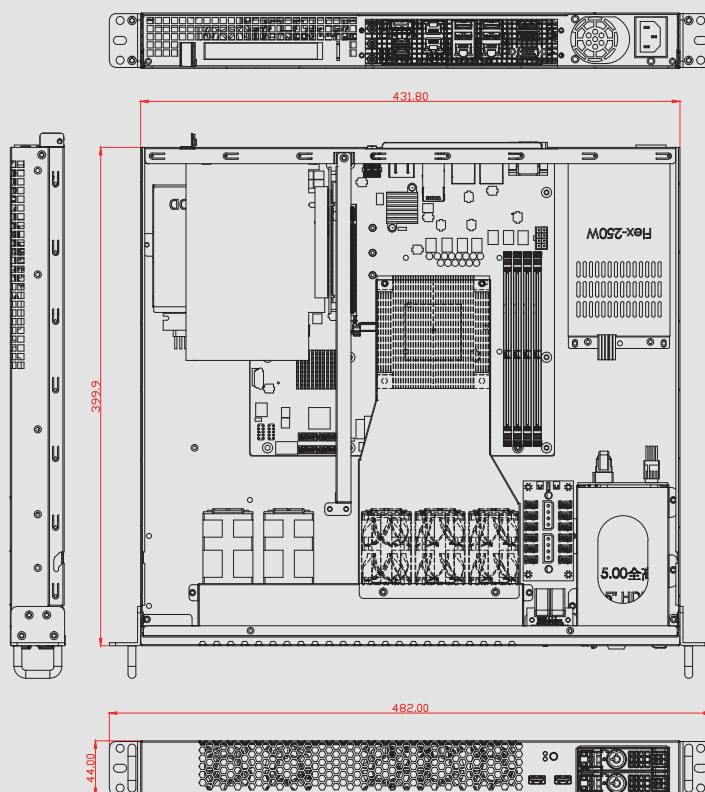

Power Solutions :

Internal Power Supply
FLEX Power Supply 250W/300W/600W/850W/1000W

UNIT:mm